

"DIN 6916"

PLAIN WASHERS FOR STEEL CONSTRUCTION

KONTRÜKSİYON PULU

SCHEIBEN FÜR STAHLKONSTRUKTIONEN

Technical informations. / Teknik bilgiler.

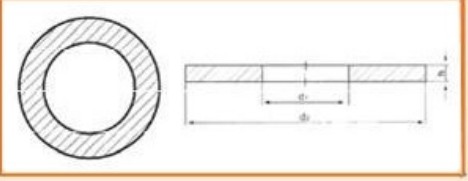

Thread size / Anma çapı		M12	M16	M20	M22	M24	M27	M30	M36
Hole dia / Delik çapı	d ₁	13	17	21	23	25	28	31	37
	max.	13.27	17.27	21.33	23.33	25.33	28.52	31.62	37.62
Outside dia / Dış çap	d ₂	24	30	37	39	44	50	56	66
	min.	23.48	29.48	36.38	38.38	43.38	49.00	54.80	64.80
Thickness / Et kalınlığı	h	3	4	4	4	4	5	5	6
	+/-	0.3	0.3	0.3	0.3	0.3	0.6	0.6	0.6
Weight / Ağırlık	gr/p	7.03	14.6	19.6	24.3	30.6	50.2	63.2	115

Values are given in millimeters. / Değerler milimetre olarak verilmiştir.

"DIN 7989"

PLAIN WASHER FOR STEEL CONSTRUCTION

KONTRÜKSİYON PULU

SCHEIBEN FÜR STAHLKONSTRUKTIONEN

Technical informations. / Teknik bilgiler.

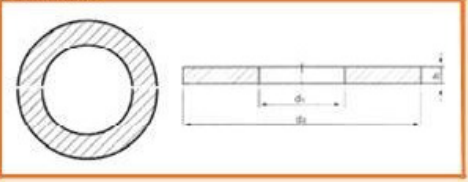

Thread size / Anma çapı		M10	M12	M16	M20	M22	M24	M27	M30	M33	M39
Hole dia / Delik çapı	d ₁	11	14	18	22	24	26	30	33	36	39
	max.										
Outside dia / Dış çap	d ₂	21	24	30	37	39	44	50	56	60	66
	min.										
Thickness / Et kalınlığı	h	8									
Weight / Ağırlık	gr/p	15.7	18.8	28.3	43.6	46.2	61.5	79.0	101	114	140

Values are given in millimeters. / Değerler milimetre olarak verilmiştir.

"DIN 9021"

LARGE SIZE WASHER

GENİŞ PUL

SCHEIBEN AUBENDURCHMESSER

Technical informations. / Teknik bilgiler.

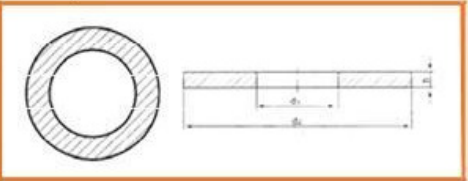

Thread size / Anma çapı		M3	M4	M5	M6	M7	M8	M10	M12	M14	M16	M18	M20	M24	M30	M36
Hole dia / Delik çapı	d ₁	3.2	4.3	5.3	6.4	7.4	8.4	10.5	13.0	15.0	17.0	20.0	22.0	26.0	33.0	39.0
	max.	3.38	4.48	5.48	6.62	7.62	8.62	10.77	13.27	15.27	17.27	20.52	22.52	26.84	34.00	40.00
Outside dia / Dış çap	d ₂	9	12	15	18	22	24	30	37	44	50	56	60	72	92	110
	min.	8.64	11.57	14.57	17.57	21.48	23.48	29.48	36.38	43.38	49.38	54.10	58.10	70.10	89.80	107.8
Thickness / Et kalınlığı	h	0.8	1.0	1.2	1.6	2.0	2.0	2.5	3.0	3.0	3.0	4.0	4.0	5.0	6.0	8.0
	+/-	0.1	0.1	0.2	0.2	0.2	0.2	0.2	0.3	0.3	0.3	0.6	0.6	1.0	1.0	1.2
Weight / Ağırlık	gr/p	0.349	0.774	1.46	2.79	5.29	6.23	12.2	22.2	31.6	40.9	67.4	76.8	139	273	522

Values are given in millimeters. / Değerler milimetre olarak verilmiştir.

"DIN 6798"

SERRATED LOCK WASHER

TIRTIKLI PUL

FACHERSCHEIBEN

Technical informations. / Teknik bilgiler.

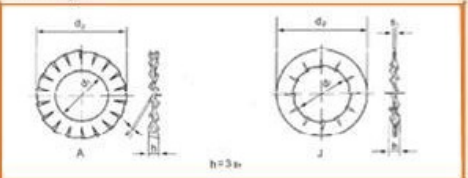

Thread size / Anma çapı		M3	M4	M5	M6	M7	M8	M10	M12	M14	M16	M18	M20	M22	M24	M27	M30
Hole dia / Delik çapı	d ₁	3.2	4.3	5.3	6.4	7.4	8.4	10.5	13.0	15.0	17.0	19.0	21.0	23.0	25.0	28.0	31.0
	max.	3.38	4.48	5.48	6.62	7.62	8.62	10.77	13.27	15.27	17.27	19.33	21.33	23.33	25.33	28.33	31.39
Outside dia / Dış çap	d ₂	6	8	10	11	13	15	18	21	24	26	30	33	36	38	44	48
	min.	5.70	7.84	9.84	10.57	12.07	14.57	17.57	19.88	23.48	25.48	29.48	32.38	35.38	37.38	43.38	47.38
Thickness / Et kalınlığı	s	0.4	0.5	0.6	0.7	0.8	0.8	0.9	1.0	1.0	1.2	1.4	1.4	1.5	1.5	1.6	1.6
Min. teeth / Min. diş	A/J	9/7	11/8	11/8	12/9	14/10	14/10	16/12	16/12	18/14	18/14	18/14	20/16	20/16	20/16	22/18	22/18
Weight / Ağırlık	gr/p	0.06	0.14	0.28	0.36	0.50	0.80	1.25	1.6	2.3	2.9	5.0	6.0	7.5	8.0	12	14

Values are given in millimeters. / Değerler milimetre olarak verilmiştir.

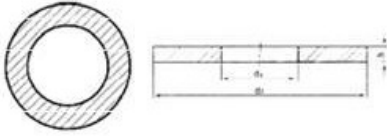

FLAT WASHER
DÜZ PUL
SCHEIBEN

Technical informations. / Teknik bilgiler.

Thread size / Anma çapı	M3	M4	M5	M6	M7	M8	M10	M12	M14	M16	M18	M20	M22	M24	M27	M30	M33	M36	M39	
Hole dia / Delik çapı	d ₁	3.2	4.3	5.3	6.4	7.4	8.4	10.5	13	15	17	19	21	23	25	28	31	34	37	40
	max.	3.38	4.48	5.48	6.62	7.62	8.62	10.77	13.27	15.27	17.27	19.33	21.33	23.33	25.33	28.33	31.39	34.62	37.62	40.62
Outside dia / Dış çap	d ₂	7	9	10	12	14	16	20	24	28	30	34	37	39	44	50	56	60	66	72
	min.	6.64	8.64	9.64	11.57	13.57	15.57	18.48	23.48	27.48	29.48	33.38	36.38	38.38	43.38	49.38	55.26	58.8	64.8	70.8
Thickness / Et kalınlığı	h	0.5	0.8	1.0	1.6	1.6	1.6	2.0	2.5	2.5	3.0	3.0	3.0	3.0	4.0	4.0	4.0	5.0	5.0	6.0
	+/-	0.05	0.1	0.1	0.2	0.2	0.2	0.2	0.2	0.2	0.3	0.3	0.3	0.3	0.3	0.3	0.3	0.6	0.6	0.6
Weight / Ağırlık	gr/p	0.119	0.308	0.443	1.02	1.39	1.83	3.57	6.27	8.62	11.3	14.7	17.2	18.3	32.3	42.3	53.6	75.3	92.1	139

Values are given in millimeters. / Değerler milimetre olarak verilmiştir.

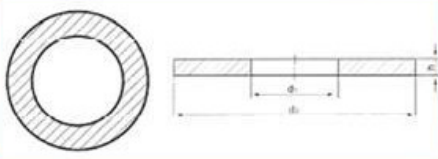

"UNC & UNF"

FLAT WASHER
DÜZ PUL
SCHEIBEN

Technical informations. / Teknik bilgiler.

Thread size / Anma çapı	1.8	5/32	3/16	1/4	5/16	3/8	7/16	1/2	5/8	3/4	7/8	1	1 1/8	1 1/4	1 1/2	
Hole dia / Delik çapı	d ₁	3	4	5	7	9	11	12	13	15	17	21	24	27	32	45
	max.	3.18	4.18	5.18	7.22	9.27	11.27	12.27	13.27	15.27	17.27	21.27	24.33	27.33	32.39	45.62
Outside dia / Dış çap	d ₂	9	12	16	17	22	26	28	33	36	40	45	48	56	65	84
	min.	8.64	11.57	15.57	16.57	21.48	25.48	27.48	32.38	35.38	39.38	44.38	47.38	55.26	63.80	83.00
Thickness / Et kalınlığı	h	1.0	1.0	1.0	1.0	1.0	1.0	1.0	3.0	3.0	3.0	3.0	3.0	6.0	6.0	3.0
	+/-	0.1	0.1	0.1	0.1	0.1	0.1	0.1	0.3	0.3	0.3	0.3	0.3	0.6	0.6	0.3
Weight / Ağırlık	gr/p	0.44	0.61	1.31	1.82	3.12	3.45	4.16	5.55	7.14	9.09	11.6	16.7	18.5	26.3	34.4

Values are given in millimeters. / Değerler milimetre olarak verilmiştir.

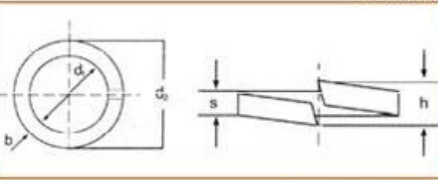

"DIN 127"

SPRING WASHER
YAYLI RONDELA
FEDERRINGE

Technical informations. / Teknik bilgiler.

Thread size / Anma çapı	M3	M4	M5	M6	M7	M8	M10	M12	M14	M16	M18	M20	M22	M24	M27	M30	M33	M36	M39	
Hole dia / Delik çapı	d ₁	3.1	4.1	5.1	6.1	7.1	8.1	10.2	12.2	14.2	16.2	18.2	20.2	22.5	24.5	27.5	30.5	33.5	36.5	39.5
	+/-	0.3	0.3	0.3	0.4	0.4	0.4	0.5	0.5	0.5	0.8	0.8	1.0	1.0	1.0	1.0	1.2	1.2	1.2	1.2
Outside dia / Dış çap	d ₂	6.2	7.6	9.2	11.8	12.8	14.8	21.1	21.1	24.1	27.4	29.4	33.6	35.9	40.0	43.0	48.2	55.2	58.2	61.2
Thickness / Et kalınlığı	s	0.8	0.9	1.2	1.6	1.6	2.0	2.5	2.5	3.0	3.5	3.5	4.0	4.0	5.0	5.0	6.0	6.0	6.0	6.0
Height / Yükseklik	h	1.9	2.1	2.8	3.8	3.8	4.7	5.9	5.9	7.1	8.3	8.3	9.4	9.4	11.8	11.8	14.2	14.2	14.2	14.2
Width / Genişlik	b	1.3	1.5	1.8	2.5	2.5	3.0	4.0	4.0	4.5	6.0	6.0	6.0	6.0	7.0	7.0	8.0	10.0	10.0	10.0
Weight / Ağırlık	gr/p	0.11	0.18	0.36	0.83	0.93	1.60	3.82	3.82	6.01	8.91	9.73	15.2	16.5	26.2	26.7	44.3	63.0	67.3	71.7

Values are given in millimeters. / Değerler milimetre olarak verilmiştir.

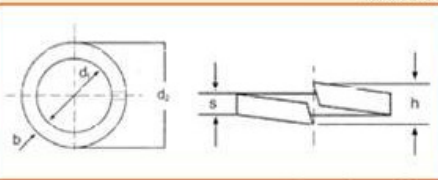

"UNC & UNF"

SPRING WASHER
YAYLI RONDELA
FEDERRINGE

Technical informations. / Teknik bilgiler.

Thread size / Anma çapı	1/8	5/32	3/16	1/4	5/16	3/8	7/16	1/2	9/16	5/8	3/4	7/8	1"	1 1/8	1 1/4	1 1/2	1 5/8	1 3/4	2"	
Hole dia / Delik çapı	d ₁	3.6	4.1	5.1	6.5	8.1	10.2	11.3	13.0	14.2	16.2	20.2	22.5	26.5	30.5	32.5	39.5	42.5	45.5	51.0
	+/-	0.3	0.3	0.3	0.4	0.4	0.5	0.5	0.5	0.5	0.8	1.0	1.0	1.0	1.2	1.2	1.2	1.2	1.2	1.5
Outside dia / Dış çap	d ₂	6.7	7.6	9.2	12.2	14.8	18.1	19.2	21.9	24.1	27.4	33.6	35.9	42.0	48.2	50.2	61.2	68.2	71.2	77.0
Thickness / Et kalınlığı	s	0.8	0.9	1.2	1.6	2.0	2.2	2.2	2.5	3.0	3.5	4.0	4.0	5.0	6.0	6.0	6.0	7.0	7.0	7.0
Height / Yükseklik	h	1.8	2.1	2.8	3.8	4.7	5.2	5.2	5.9	7.1	8.3	9.4	9.4	11.8	14.2	14.2	14.2	16.5	16.5	16.5
Width / Genişlik	b	1.3	1.5	1.8	2.5	3.0	3.5	3.5	4.0	4.5	5.0	6.0	6.0	7.0	8.0	8.0	10.0	12.0	12.0	12.0
Weight / Ağırlık	gr/p	0.12	0.18	0.36	0.93	1.60	2.53	3.00	3.95	6.01	8.91	15.2	16.5	27.5	44.3	44.3	71.7	111	117	152

Values are given in millimeters. / Değerler milimetre olarak verilmiştir.

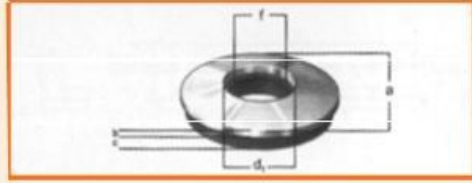

EPDM BONDED WASHERS

EPDM PUL

EPDM SCHEIBEN

Technical informations. / Teknik bilgiler.

Thread size / Anma çapı		14	16	19
Outside dia / Dış çap	a	14	16	19
	+/-	0.15	0.15	0.15
Inside dia / İç çap	d	5.50	6.80	6.80
EPDM dia / EPDM çapı	f	3.90	4.20	5.10
Metal thc./ Metal kal.	b	0.80	0.80	0.80
EPDM thc. / EPDM kal.	c	2.00	2.00	2.00
Weight / A ırlık	gr/p	1.22	1.53	2.25

Values are given in millimeters. / Değerler milimetre olarak verilmiştir.

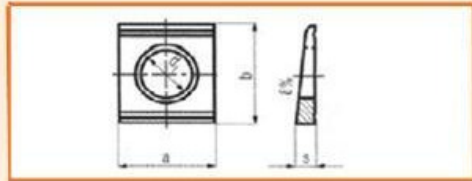

"DIN 434"

SQUARE TAPER STEEL WASHER FOR CHANNELS

KARE U PUL

SCHEIBEN VIERKANT FÜR U TRAGER

Technical informations. / Teknik bilgiler.

Thread size / Anma çapı		M8	M10	M12	M16	M20	M22	M24	M27
Hole dia / Delik çapı	d1	9.0	11.0	13.5	17.5	22.0	24.0	26.0	30
Outside mea / Dış ölçü	a	22	22	26	32	40	44	56	56
	min.-max	± 2	± 2	± 2	± 2.5	± 2.5	± 2.5	± 3	± 3
	b	22	22	30	36	44	50	56	58
Thickness / Et kalınlı ı	min.-max	± 0.65	± 0.65	± 0.65	± 0.8	± 0.8	± 0.8	± 0.95	± 0.95
	h	3.8	3.8	4.9	5.9	7.0	8.0	8.5	8.5
Weight / A ırlık	gr/p	9.570	8.850	18.200	31.40	56.90	82.30	128.00	119.00

Values are given in millimeters. / Değerler milimetre olarak verilmiştir.